

Rainwater Systems

Cillit Rainwater Backwater Filter

- Easy Clean - no need to change cartridges
- Simple backwash filter cleaning
- Black UV stable opaque filter casing
- Removes sediment and debris in the plumbing line to reduce plumbing fixture failure.



Cillit Rainwater Backwash Filter

Installation

This product is designed to be installed after the pump and before the interconnection device in a rainwater tank application. The product removes sediment and debris in the plumbing line connecting from the rainwater tank, reducing the risk of fixture failure from floating sediment.

If inlet pressure of the water is greater than 600 kPa a pressure reducing device should be installed. Do not connect in a situation where there is water hammer or strong and/or frequent oscillation of pressure to avoid damage or breakage.

Product should be installed with an isolation valve before the unit and barrel unions to allow servicing or replacement of the unit if required. **The unit must not be installed on Mains Pressure Water Lines (do not install downstream of any interconnection device that has mains water connected to it). Hand tighten only B, H & I.**

Commissioning

Check that all connections are tight and the isolation valve prior to the unit and drain cock valves are in a closed position. Install a tun dish or attach a short hose to the outlet of the drain cock to direct the water flow to a suitable position. Slowly open the isolation valve prior to the unit. De-aerate the line by opening B, then open the drain cock and turn the backwashing knob. Wash for 30 seconds before closing the drain cock. Pump needs to be operating in order to backwash.

Maintenance

The filter should be backwashed at least once a month to avoid the deposit build-up of foreign particles on the filter mesh. In the case of excessive accumulation of dirt the unit should be backwashed more frequently.

To clean the filter open the drain cock and rotate the backwashing knob. Wash for at least 30 seconds and then close the drain cock.

The plastic parts can be cleaned with a soft damp cloth. Avoid the use of solvents, cleaners and detergents containing acids or alcohol. For best results we recommend the installation of a quality inlet filter to the rainwater tank/s.

Above Ground External Pump

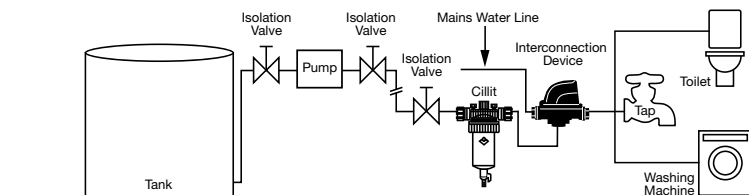

Underground Submersible External Pump

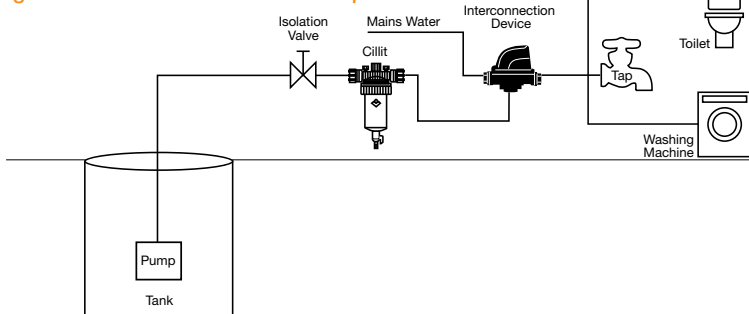

Warranty

This product is covered by a 12 month warranty. This warranty covers faults in the product construction, material and assembly. Faulty products will be repaired or exchanged free of charge. Faulty items become our property.

This warranty does not include faults caused by:

- Unsuitable or improper use
- Normal wear and tear
- Chemical, electrochemical or electrical influences
- Incorrect installation
- Inadequate or complete lack of maintenance
- connection to mains water

To the maximum extent permitted by law, Reece excludes all warranties other than those set out above. In the event of a warranty claim, we will replace or repair defective products, or pay for the cost of having defective products repaired or replaced, but will not be liable for any injury to any person, damage to any property, any indirect or consequential loss, or in any other respect.

Spare parts

- A. Backwashing Knob
- B. Deaeration
- C. Head
- D. Washing Unit
- E. Filter Element
- F. O-Ring Nut
- G. Filter Casing
- H. Ring
- I. Drain Cock

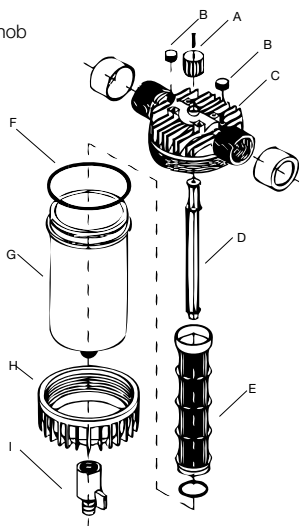

Technical Data

Connections	25mm (1") female
Max Pressure	600 kPa
Max Water Temp	30°C
Max Ambient Temp	40°C
Pressure Drop	20 kPa @ 58 L/min
Filter Screen	90 micron

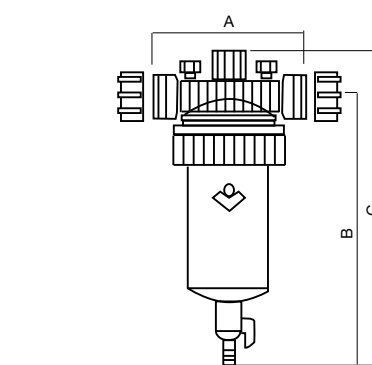

Dimensions

A	161mm
B	292mm
C	340mm

Reece. Works for you.™

Call 1800 032 566 or visit www.reece.com.au

Due to limitations in the printing process the colours in this brochure are a guide only. The manufacturer/distributor reserves the right to vary specifications or delete models from their range without prior notification. The manufacturer/distributor takes no responsibility for printing errors.

V2 [BROCHURE CODE 2130466]

