



# Series One

## The New Compact Fitting

Technical Catalogue



STANDARDSMARK  
LICENSE NO. 2018  
AS/NZS 4129

Global Presence - Local Commitment







**Series One** - The new range of innovative fittings created by Plasson, market leader in design and manufacture of reliable fittings for polyethylene pipe systems.

**Series One** push-fittings provide connectivity of PE pipe to a variety of plumbing pipe materials including PE and PEX. Inserting the pipe up to the fitting stop creates both the seal and the grip on the pipe.

**Series One** is designed to provide a 16 Bar rated joint to PE pipe in cold water applications.

**Series One's** compact and attractive design makes this fitting ideal for the plumbing market, where space is limited and appearance is crucial. Simplicity of assembly makes both the professional's and occasional user's job easier while retaining Plasson reputation for quality and long term reliability.

The combination of Plasson's current fitting range and the new Series One fulfill the requirements of all markets for PE pipe connections and connections to other pipe materials.

**Series One features and benefits include:**

- Aesthetically designed product - gives a professional finish to the job
- Assembly tools not required - simple push fit assembly
- Compact size - can be assembled in confined spaces
- Instant seal and integrity of joint - captive seal and no nuts to tighten
- Full end load performance - no need to restrain joints
- Transition PE to PEX plumbing systems accommodated in one fitting
- Same assembly method for PE and PEX pipe
- 50 year design life to AS/NZS 4129 PN16 - provides total reliability
- Tamper resistant design - ensures system integrity
- Compact design requires reduced storage space
- Can be easily disassembled using the Series One specialised wrench

**Coupler**

**1001**

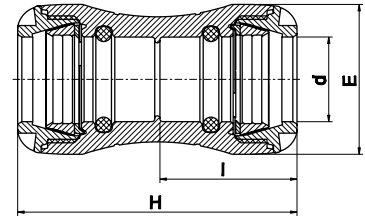

Reece Code	Size d	E	H	I
1410320	20	41	92	45
1410321	25	47	98	48
1410322	32	58	108	53
1410323	40	70	142	70
1410324	50	85	158	78
1410325	63	103	183	90

**End Plug**

**1012**

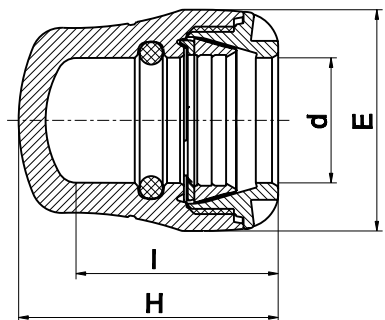

Reece Code	Size d	E	H	I
1410352	20	41	56	45
1410353	25	47	60	48
1410354	32	58	68	53
1410355	40	70	90	71
1410356	50	85	102	79
1410357	63	103	117	91

## Male Adaptor

1002

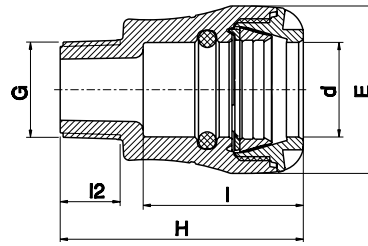

Reece Code	Size d x G	E	H	I	l2
1410326	20 x 1/2"	41	70	45	16
1410327	20 x 3/4"	41	71	45	17
1410328	25 x 1/2"	47	75	48	16
1410329	25 x 3/4"	47	76	48	17
1410330	25 x 1"	47	78	48	19
1410331	32 x 3/4"	58	82	55	17
1410332	32 x 1"	58	84	55	19
1410333	32 x 1 1/4"	58	86	55	21
1410334	40 x 1"	70	104	73	19
1410335	40 x 1 1/4"	70	106	73	21
1410336	40 x 1 1/2"	70	106	73	21
1410337	50 x 1 1/2"	85	114	81	21
1410338	50 x 2"	85	118	81	25
1410339	63 x 1 1/2"	103	125	92	19
1410340	63 x 2"	103	129	92	25

## Female Adaptor

1003

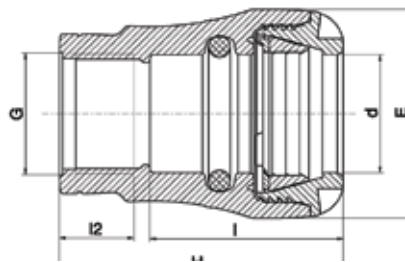

Reece Code	Size d x G	E	H	I	l2
1410368	20 x 1/2"	41	67	45	17
1410369	20 x 3/4"	41	71	45	18
1410370	25 x 1/2"	47	7	48	17
1410371	25 x 3/4"	47	71	48	18
1410372	25 x 1"	47	80	48	21
1410373	32 x 3/4"	58	77	54	18
1410374	32 x 1"	58	79	54	21
1410375	32 x 1 1/4"	58	90	54	24

## Reducing Coupling

1011

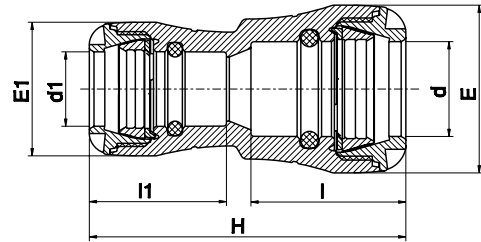

Reece Code	Size d x d1	E	H	I	E1	I1
1410349	25 x 20	47	100	48	41	45
1410350	32 x 20	58	106	54	41	45
1410351	32 x 25	58	110	54	47	48

## 90° Tee

1004

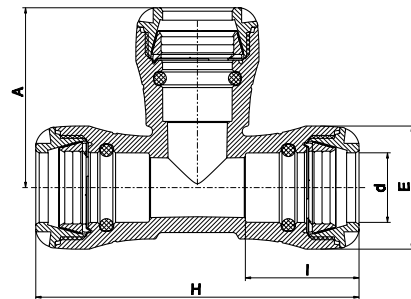

Reece Code	Size d	E	H	A	I
1410341	20	41	123	71	45
1410342	25	47	134	78	48
1410343	32	58	152	84	54
1410387	40*	70	192	108	70
1410388	50*	85	214	124	78
1410389	63*	103	262	147	90

\* Estimated availability Q3.2010.

**90° Elbow**

**1005**

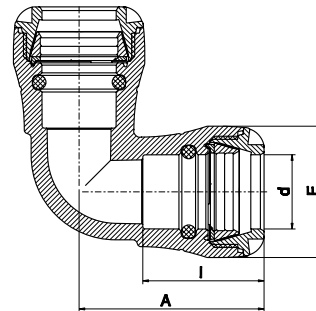

Reece Code	Size d	E	A	I
1410344	20	41	67	45
1410345	25	47	73	48
1410346	32	58	81	54
1410347	40	70	106	70
1410348	50	85	119	78
1410390	63	103	141	90

**90° Elbow with Threaded Male Offtake**

**1085**

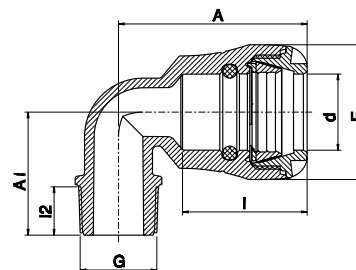

Reece Code	Size d x G	E	A	I	A1	l2
1410358	20 x 1/2"	41	66	45	41	16
1410359	20 x 3/4"	41	66	45	42	17
1410360	25 x 1/2"	47	74	48	44	16
1410361	25 x 3/4"	47	73	47	45	17
1410362	25 x 1"	47	73	47	47	19
1410363	32 x 3/4"	58	81	53	51	17
1410364	32 x 1"	58	81	53	53	19
1410365	32 x 1 1/4"	58	81	53	54	21

**Brass Male Adaptor**

**1072**

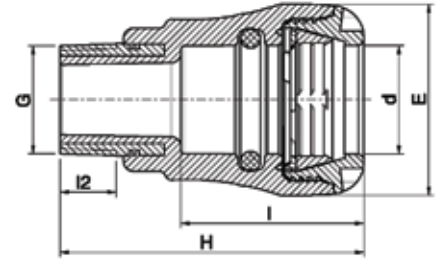

Reece Code	Size d x G	E	H	I	l2
1410391	20 x 1/2"	41	76	45	13
1410392	20 x 3/4"	41	77	45	15
1410393	25 x 1/2"	47	79	48	13
1410394	25 x 3/4"	47	80	48	15
1410395	25 x 1"	47	85	48	17
1410376	32 x 3/4"	58	88	55	15
1410377	32 x 1"	58	92	55	17
1410378	32 x 1 1/4"	58	100	55	19
1410379	40 x 1"	70	110	73	17
1410380	40 x 1 1/4"	70	113	73	19
1410381	40 x 1 1/2"	70	113	73	19
1410382	50 x 1 1/2"	85	120	81	19
1410383	50 x 2"	85	127	81	23
1410384	63 x 1 1/2"	103	132	92	19
1410385	63 x 2"	103	139	92	23

**Brass Female Adaptor**

**1073**

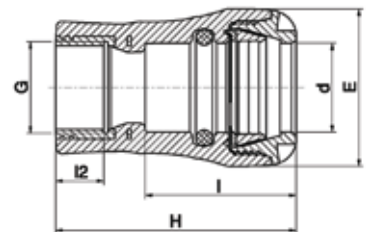

Reece Code	Size d x G	E	H	I	l2
1410396	20 x 1/2"	41	73	45	15
1410397	20 x 3/4"	41	80	45	16
1410398	25 x 1/2"	47	76	48	15
1410399	25 x 3/4"	47	78	48	16
1410400	25 x 1"	47	89	48	19
1410401	32 x 3/4"	58	86	56	16
1410386	32 x 1"	58	88	56	19
1410402	32 x 1 1/4"	58	98	56	21

## Series One Wrench

Reece Code	Size
1410367	20 - 32
1410366	40 - 63



## Nut

10004

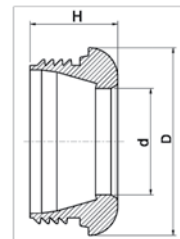

Reece Code	Size d	D	H
1410403	20	40	22
1410404	25	45	22
1410405	32	57	24
1410406	40	68	33
1410407	50	83	37
1410408	63	100	43

## O-Ring

10002

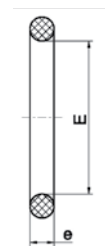

Reece Code	Pipe Size	E	e
1410409	20	19	4
1410410	25	24	5
1410411	32	31	6

**Shaped Seal**

**100029**



Reece Code	Pipe Size	E	e
1410412	40	38	10
1410413	50	48.6	10.5
1410414	63	60.6	11.2

**Split Ring**

**10003**

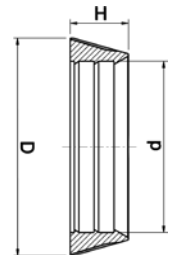

Reece Code	Size d	D	H
1410415	20	27	9
1410416	25	32	9
1410417	32	41	11
1410418	40	52	14
1410419	50	64	17
1410420	63	81	21

**Grip Ring**

**10008**

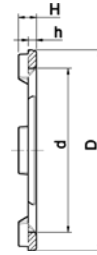

Reece Code	Size d	D	H	h
1410421	20	27	3.7	1.7
1410422	25	33	3.7	1.7
1410423	32	47	3.7	1.7
1410424	40	52	4.0	2.2
1410425	50	64	4.3	2.5
1410426	63	80	4.8	3.0

## Installation Instructions

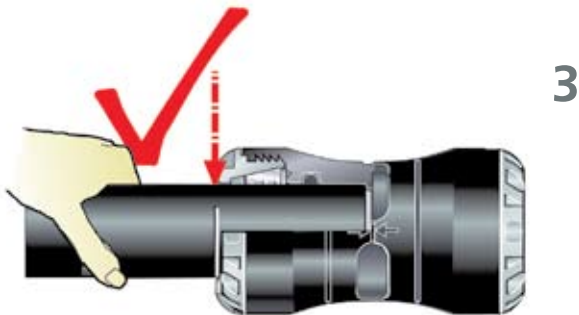
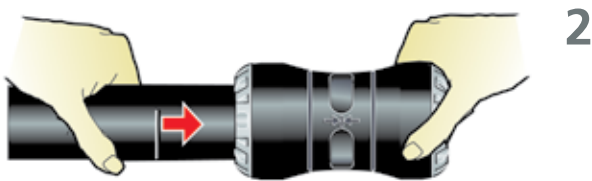
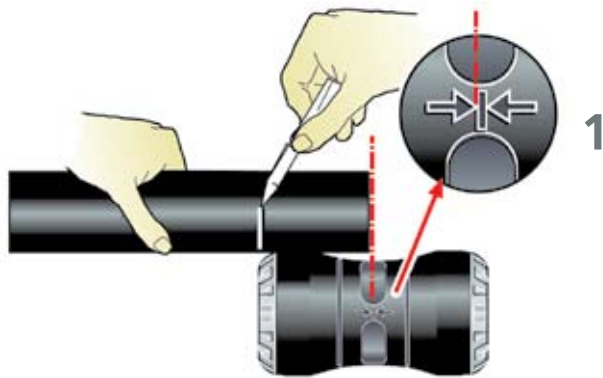

### **Note**

Before installation ensure that the end of the pipe to be inserted into the fitting is free of scratches and other imperfections and that both the pipe and the fitting itself are free of sand, mud, stones, etc. If fittings are reused, ensure that split ring and grip ring teeth are sharp and bite into the pipe, to avoid pullouts. If uncertain, replace the split ring and grip ring.

For diameters 40mm and above, chamfering and lubrication of the pipe end will ease insertion (use silicone lubricant).

## Disassembly

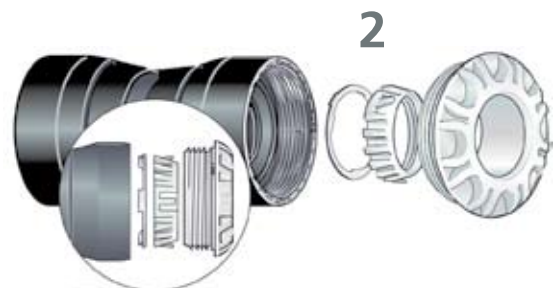
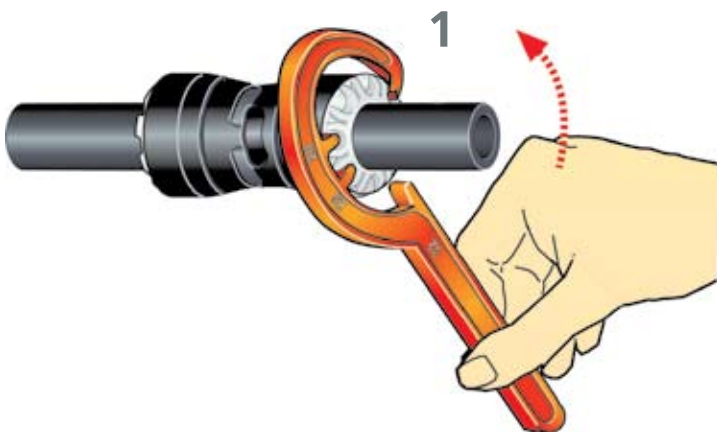

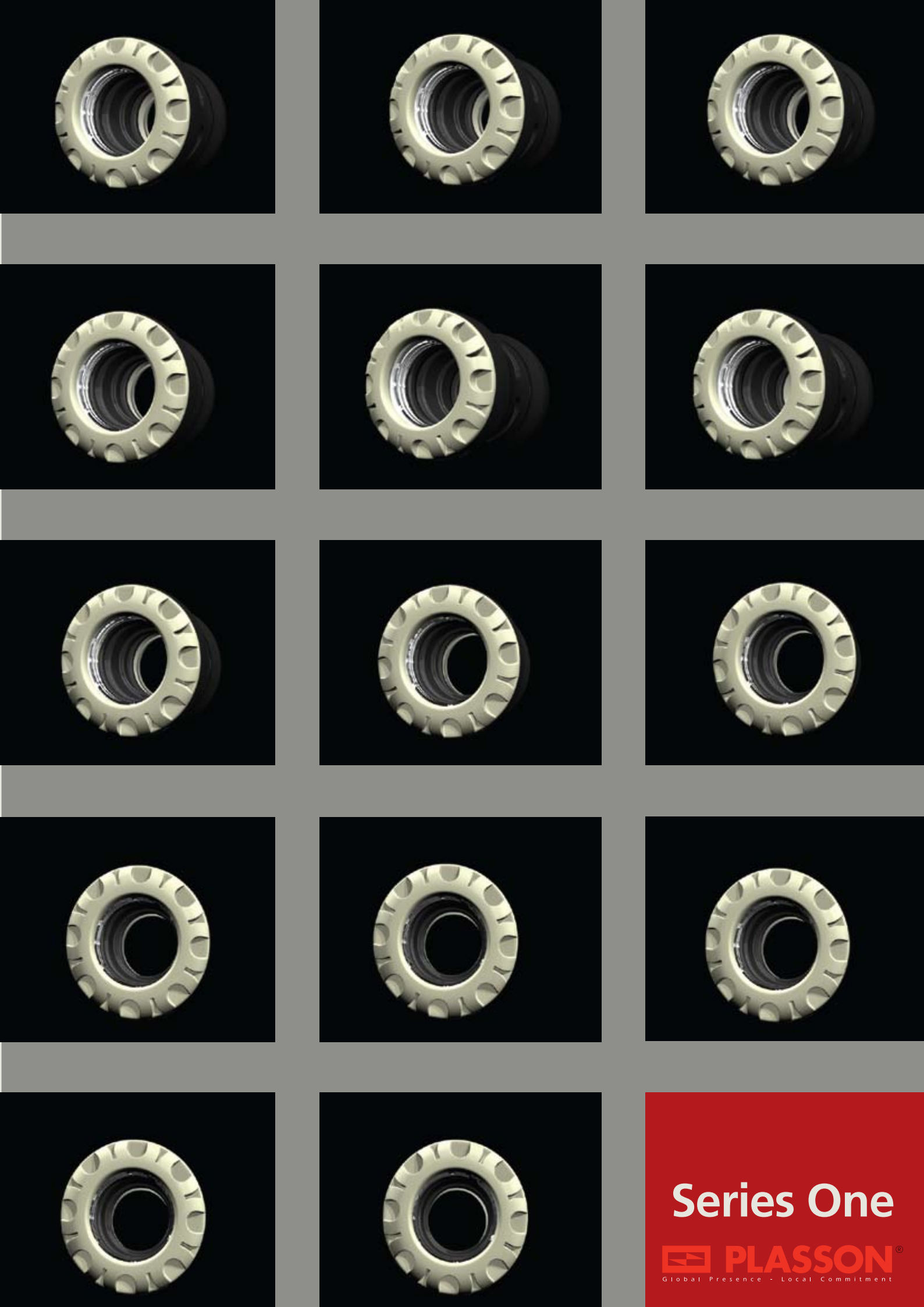

Series One

 **PLASSON**<sup>®</sup>  
Global Presence - Local Commitment

## Technical Specifications

### Materials

#### Compression Fittings

**Body:** Polypropylene, high grade copolymer

**Nut:** High Grade Polypropylene

**Split Ring and Grip Ring:** Acetal (POM)

**Seal:** Nitrile rubber (NBR)

**Reinforcing Ring:** Stainless steel on all female offtakes from 1¼" up to 2"

#### Threaded Fittings

**Body:** Polypropylene, high grade copolymer

**Reinforcing Ring:** Stainless steel

**Brass Threads:** CZ132 EN12164

### Operating Temperatures

The fittings are not to be used with hot water, although they withstand the same temperature as the polyethylene pipe itself.

The fittings will withstand sub-zero temperatures. For applications with operating temperatures above 20°C refer to the pressure derating factors on the Plasson website.

### Chemical Resistance

Plasson fittings are supplied, as standard, with polyacetal split and grip rings and NBR seals which are suitable for water.

For other applications refer to the Plasson Australia website or contact your Plasson representative.

### Operating Pressures and Quality Certificates

Plasson fittings sizes 20-63 are tested and approved according to AS/NZS 4129 PN16.



STANDARDSMARK  
LICENSE NO. 2018  
AS/NZS 4129

### Threads

All threads conform to ISO - 7/1, BS 21 - 1973, DIN 2999, NEN 3258, AS 1722 Part 1- 1975.

All external threads are tapered.

All internal threads are parallel.

**Note:** We strongly recommend the use of PTFE tape in threaded connections.





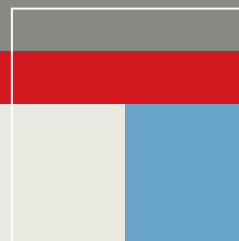

## **PLASSON**<sup>®</sup>

PLASSON Australia PTY. LTD.

Unit 3, 53-57 Burrows Road

Alexandria NSW 2015, Australia

Tel: +61 2 9550 2291

Fax: +61 2 9550 1522

E-mail: [info@plasson.com.au](mailto:info@plasson.com.au)



[www.plasson.com.au](http://www.plasson.com.au)