



1. Why get a professional Reece Irrigation Design from Reece Irrigation & Pools?

Whether you're creating a lush lawn or a grand garden, it all starts with care and preparation. The Reece Irrigation Design team are committed to helping you achieve the most effective, water efficient solution to suit your needs.

Our free CAD drawn plans offer clear and precise direction for setting out your system, with installation schematics and valve wiring tables to ensure your system will be installed as the designer intended.

With an extensive range of quality products at our disposal, as well as IAL certified irrigation designers on staff, there is no better place to find the right products and advice.

2. What is a 'bucket test' and how do I do this?

Firstly, turn off all taps and household appliances (that may be using water) and select the tap(s) which you propose your irrigation system to be supplied from. Flow and pressure will be better the closer you are to your water meter.

Turn the tap to fully open and place a standard 9 litre household bucket underneath, then time (in seconds) how long it takes to fill the bucket to the very top. Record this time and provide the seconds to the Reece Irrigation Design Team.

Alternatively, all Reece Irrigation & Pools branches have a testing device available to provide a more accurate flow, at pressure, in which you can borrow from them for a \$100.00 fully-refundable deposit.

3. If I don't have a landscape or site plan, how do I draw up my garden?

There are various online drawing tools and programs to allow you to draft up a plan of your site for free; however all of them will require you to provide some physical measurements on-site to at least get you started.

You can find a guide for collecting dimensions of your site here (please read on).

NOTE: the accuracy of our irrigation plan is dependent upon the accuracy of the drawing and information provided by you. Reece will not be liable for any errors due to incorrect drawings, dimensions or specifications submitted to us.

Collecting dimensions of your property

There are some measurements we need you to provide if you do not have a scaled landscape plan or site plan provided by others. These measurements will help us to provide you with an accurate irrigation drawing.

Ideally, these measurements should be drafted on a piece of graph paper TO SCALE and scanned to a PDF. The PDF can then be submitted with your request.

STEP 1

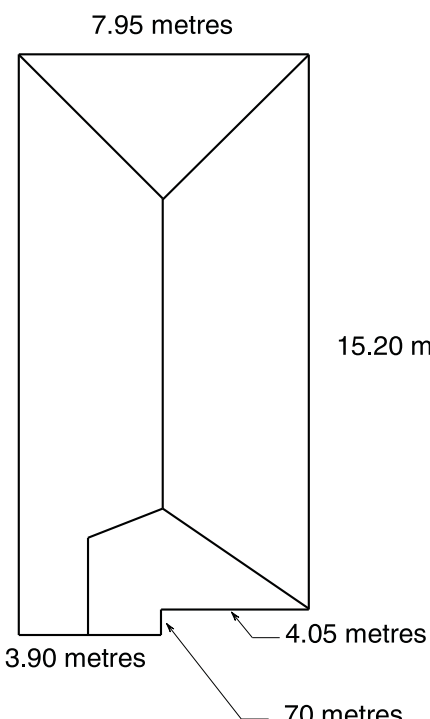

Draw the outline of your home, buildings or solid structures.

- Use simple lines.
- Include the associated distance of each line you draw.
- We have started this example with the house that generally would have 90-degree angles which the user can work from and build their drawing from a fixed point. This will assist with improving the accuracy of other items such as fence line boundary, garden beds and lawn areas.

STEP 2

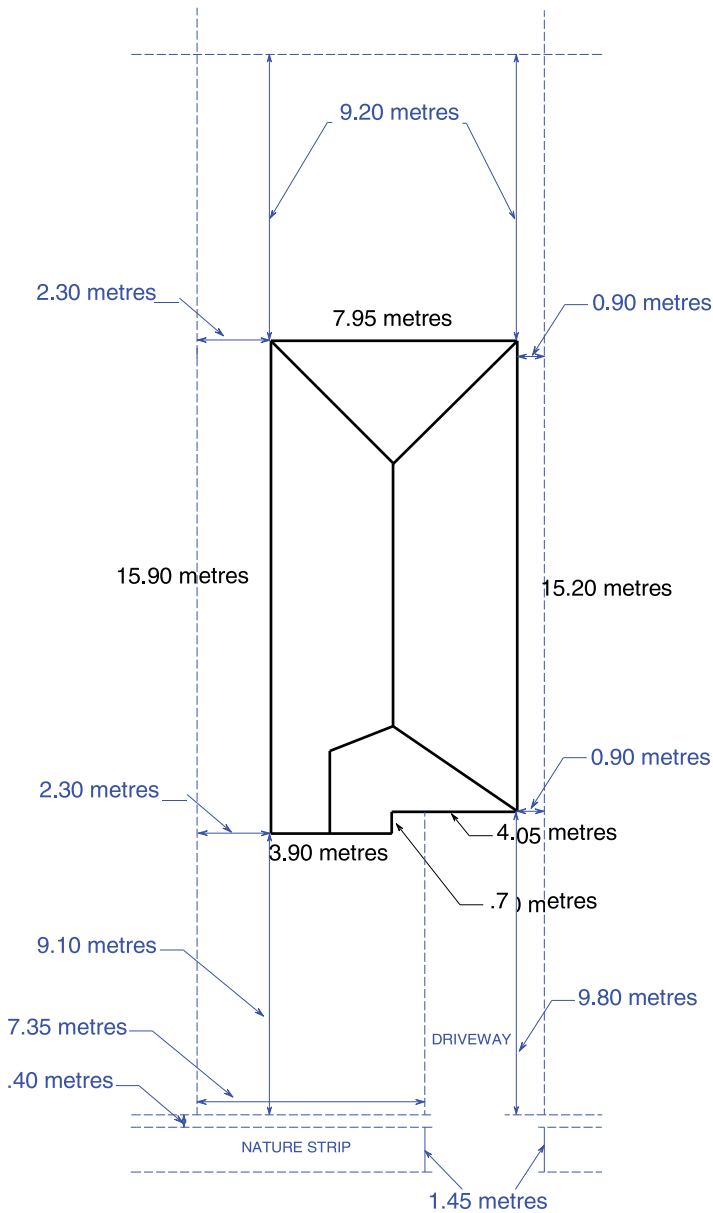

Draw the boundary of your site.

- Draw straight lines off each angle of your home, building or solid structure to the boundary and note the distance of each line.
- Note the reference lines determining the distance from the fixed structure (house) to the boundary line (fence line). These markings will allow the user to establish the correct placement of the building with the property boundary line (in this example the fence line). These can be deleted from within the online planner after the dashed lines have been confirmed.
- Dashed lines represent the alignment of the outer perimeter.

STEP 3

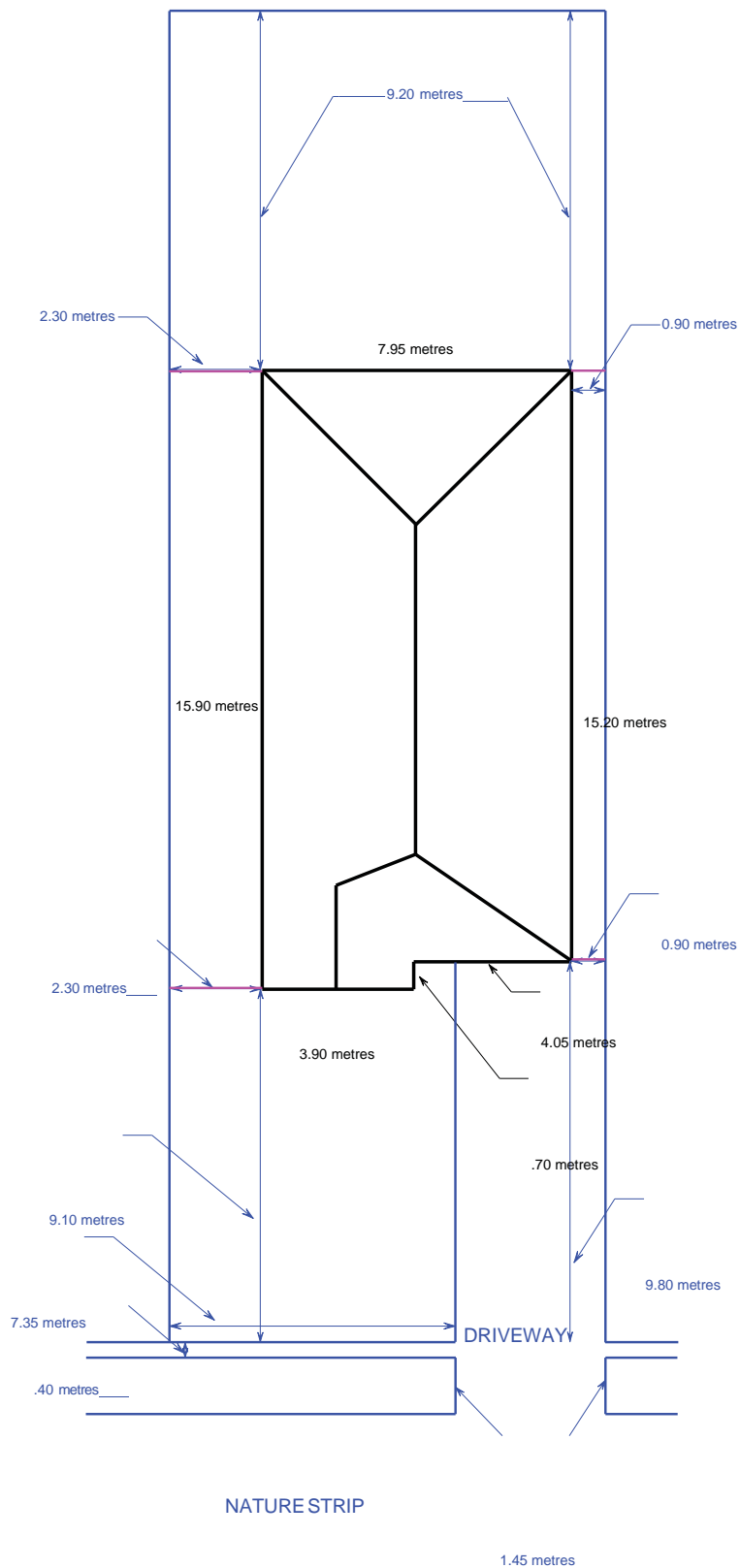

Draw other fixed structures

- For any fixed structure such as a pool, shed, garage or paved area, take measurements off the main outline drawn in step one.
- Draw the outline of the fixed structure.
- Include the associated distance of each line you draw.
- Label the outlined fixed structure eg. Pool.

STEP 4

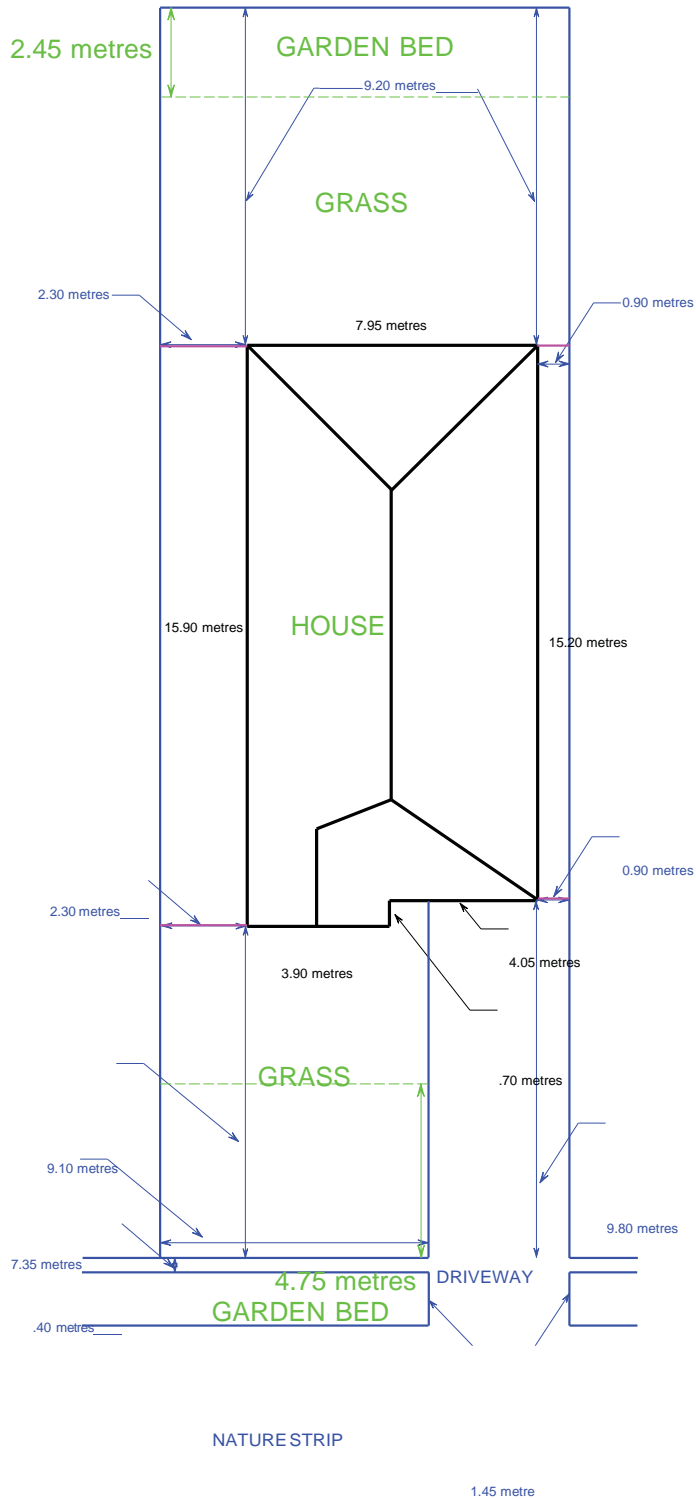

Draw areas to be irrigated.

- For any areas to be irrigated, take measurements off the main outline as per step 1.

Consider:

- lawn
- trees
- garden bed
- drought tolerant plants
- vegetable garden
- thirsty plants

For trees note the width of the widest point of the tree such as the tree top/ canopy.

- Draw the outline of the areas to be irrigated.
- Label the outlined areas to be irrigated eg. Garden bed.

STEP 5

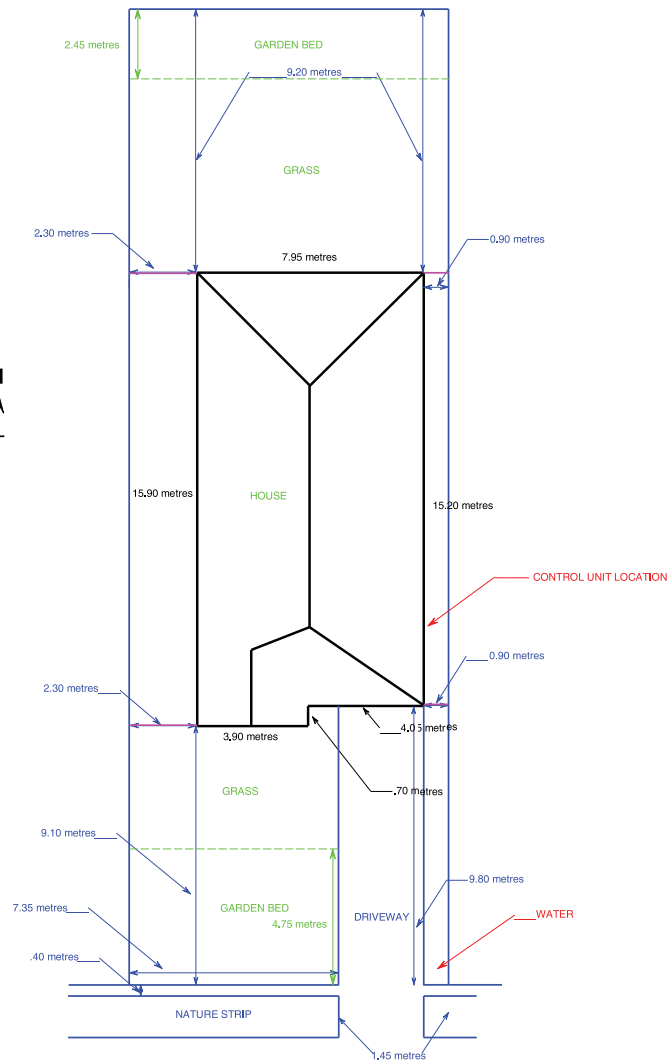

Draw your water sources and best place for an automatic timer.

Draw the location of any of the following:

- bore water
- north symbol
- tanks
- taps
- water meter
- external power point. This is required if you have an automatic timer.