

EVERHOT®

Made by Rheem Manufacturing

- ✓ Great Value
- ✓ Great Quality
- ✓ Made by Rheem Manufacturing

Everhot. Job Done!



CONTENTS



DUAL HANDED
ELECTRIC

03



STAINLESS
STEEL ELECTRIC

05



4 STAR GAS
STORAGE

07



5 STAR GAS
STORAGE

09



450+ STAINLESS
STEEL 5 STAR
GAS STORAGE

11



EVERHOT PRO
(HEAVY DUTY
ELECTRIC)

13



HEAVY DUTY
GAS

15



BOILING
WATER

17

EVERHOT®

Everhot offers a leading range of popular water heater models manufactured and supported by Rheem, Australia's No.1 water heater manufacturer. With most products made locally, expect nothing less than exceptional quality and value for money, and access to a national parts and service network. Whether it's hot water for the family home or a commercial application, Everhot's the right choice to get the job done.



DUAL HANDED ELECTRIC



ELECTRIC



DELIVERY



CYLINDER
WARRANTY^{1,2}



INSTALLATION³



DUAL
HANDED

Everhot dual handed electric water heaters feature a durable vitreous enamel lining, and reliable performance you expect from a product manufactured by Rheem. They offer outstanding value, and come in a wide range of models with a capacity to suit most domestic applications.

FEATURES

- Complete model range (25L – 400L)
- Fast, easy like-for-like replacement
- Dual handed inlet and outlet fittings
- Mains pressure
- 25L – 125L models feature compact dimensions and easy to access fittings
- Plug in models available in 25L and 50L³
- 160L – 400L models suit connection to concessional (off-peak) tariffs
- Twin element models available in 250L, 315L and 400L
- 7 year cylinder warranty¹ on 25L and 50L models
- 10 year cylinder warranty² on 80L, 125L, 160L, 250L, 315L and 400L models
- Full warranty support through a comprehensive national service network



Excludes 25L, 50L, 80L and 125L electric vitreous enamel models.

SPECIFICATIONS		25L	50L	80L	125L	160L	250L	315L	400L
Dual Handed Electric – Single Element	Everhot Model Number	291025 291025/P³	291050 291050/P³	281080	281125	271160	291250	291315	291400
	Reece Product Code	1303672 1303673³	1303674 1303675³	1303676	1303678 (3.6kW) and 1303677 (1.8kW)	1303564 (3.6kW) and 1303563 (2.4kW)	1303565 (3.6kW) and 1303566 (4.8kW)	1300794 (3.6kW) and 1300795 (4.8kW)	1303567
Dual Handed Electric – Twin Element	Everhot Model Number						292250	292315	292400
	Reece Product Code						1303927	1303928 (3.6kW) and 1303929 (4.8kW)	1303930
Hot Water Delivery	Litres	25	50	80	125	160	250	315	400
Boost Capacity	Litres	–	–	–	–	–	50	50	90
kW Rating	1.8	–	–	–	✓	–	–	–	–
	2.4	✓	✓	–	–	✓	–	–	–
	3.6	✓	✓	✓	✓	✓	✓	✓	–
	4.8	–	–	–	–	–	✓*	✓	✓
Relief Valve Setting	kPa	1000	1000	1000	1000	1000	1000	1000	1000
Expansion Control Valve	kPa	850	850	850	850	850	850	850	850
Max Water Supply Pressure:									
with ECV	kPa	680	680	680	680	680	680	680	680
without ECV	kPa	800	800	800	800	800	800	800	800
Water Hot and Cold Connections		Rp ¾	Rp ¾	Rp ¾	Rp ¾	Rp ¾	Rp ¾	Rp ¾	Rp ¾
Dimensions									
A	mm	430	695	875	1250	1610	1395	1640	1840
B	mm	400	400	460	480	480	640	640	690
C	mm	436	436	492	515	515	680	680	730
D	mm	106	397	475	852	1332	1112	1317	1479
E	mm	142	142	194	195	104	73	113	121
F	mm	60	60	112	112	66	103	103	105
G	mm	–	–	–	–	–	988	1228	1323
H	degrees	26	26	22	22	23	32	32	30
J	degrees	64	59	60	60	58	88	88	83
M	degrees	–	–	–	–	58	92	92	97
Approx. Weight (inc. packaging)	kg	19	26	32	45	59	82	97	120

Technical data is subject to change.

*4.8kW element rating not available in 250L twin element model range.

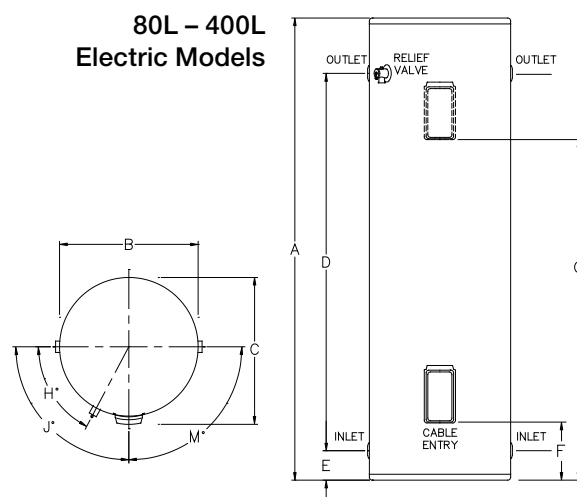
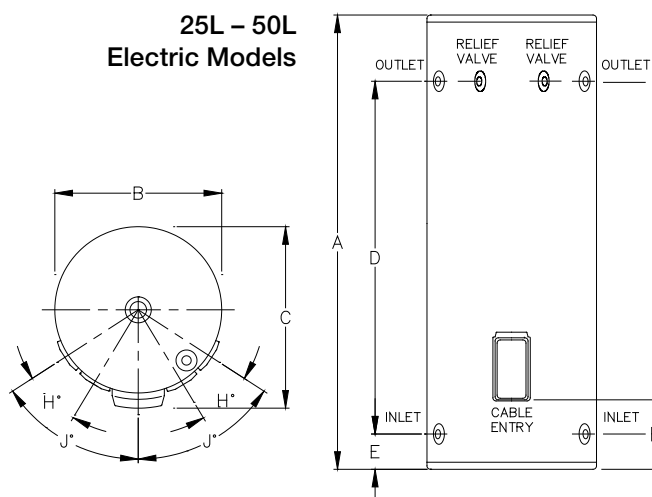

1. Warranty (25L and 50L): 7 Years on Cylinder, 1 Year Labour on Cylinder, 1 Year Parts and Labour warranty on all other components for Domestic (non-Commercial) installations. Conditions apply. See the Everhot warranty set out in the Owner's Guide and Installation Instructions or view online at www.reece.com.au/Everhot.
2. Warranty (80L, 125L, 160L, 250L, 315L and 400L): 10 Years on cylinder, 1 Year Labour on Cylinder, 1 year Parts and Labour warranty on all other components for Domestic (non-Commercial) installations. Conditions apply. See the Everhot warranty set out in the Owner's Guide and Installation Instructions or view online at www.reece.com.au/Everhot.
3. 25 and 50 litre flex and plug models may only be used indoors.



STAINLESS STEEL ELECTRIC



ELECTRIC

50L
250L
315L

DELIVERY

1 - 6

PEOPLE⁷

10
YEAR

CYLINDER
WARRANTY⁴

Indoor/
Outdoor

INSTALLATION

With a stainless steel cylinder and water fittings, Everhot Stainless Steel electric water heaters offer maximum longevity and reduced lifetime maintenance costs in an easy to handle, lightweight package. And with superior insulation, they comfortably outperform regulated Minimum Energy Performance Standards (MEPS)⁶.

FEATURES

- Available in 50L, 250L and 315L capacities to suit most applications
- Stainless steel cylinder and fittings resist corrosion for longer, extending product life
- Up to 40% lighter⁵ for easier handling
- No anode, to reduce lifetime maintenance costs
- Up to 19% better than MEPS⁶ reducing energy use to save you money
- Hi-temp 80°C thermostat (50L model only)
- Dual handed fittings for easier installation (50L model only)
- Made in Australia
- 10 Year cylinder warranty⁴
- Mains pressure
- Full warranty support through a comprehensive national service network



SPECIFICATIONS		50L	250L	315L
Stainless Steel Electric	Everhot Model Number	2A1050	2A1250	2A1315
	Reece Product Code	1306813	1306814	1306815
Hot Water Delivery	Litres	50	250	315
No. of People (moderate climate) ⁷	Continuous Tariff	1-2	3-5	4-6
No. of People (moderate climate) ⁷	Off Peak/Night rate	N/A	1-3	2-4
kW Rating	kW	3.6	3.6	3.6
Maximum Supply Pressure				
with ECV	kPa	960	680	680
without ECV	kPa	1120	800	800
T&PR Valve	kPa	1400	1000	1000
ECV setting	kPa	1200	850	850
Thermostat Setting (maximum)	°C	80	75	75
Water Hot and Cold Connections		Rp ¾ Female		
PTR Connections		Rp ½ Female		
Better than MEPS ⁶ by		4.8%	19%	17%
Dimensions				
A	mm	695	1440	1760
B	mm	400	620	620
C	mm	432	630	630
D	mm	385	1000	1320
E	mm	145	220	220
F	mm	93	145	145
H	degrees	30	30	30
J	degrees	60	60	60
M	degrees	60	120	120
Approx. Weight (inc. packaging)	kg	15.9	44.8	52.9

Technical data is subject to change.

Everhot Stainless Steel water heaters are not recommended for installation in some areas.

Refer to www.reece.com.au/Everhot for details of areas not recommended and where, if installed, product is not covered by warranty.

50L models have left and right hand (dual handed - DH) cold water connections, hot water connections, and T&PR valve fittings.

250L-315L models have left and right hand (dual handed - DH) cold water connections, a hot water connection at the top of the water heater and a T&PR valve fitting on the left hand side.

Note: Allow additional top clearance for the hot outlet fittings and pipe work.

- Warranty: 10 Year cylinder warranty, 1 Year parts and labour on all other components for domestic (non-commercial) installations. Conditions apply. See the Everhot warranty set out in the Owner's Guide and Installation Instructions or view online at www.reece.com.au/Everhot.
- Up to 40% lighter than comparable Everhot vitreous enamel water heater models of same capacity.
- Minimum Energy Performance Standard (MEPS) is a regulated requirement that electric water heaters sold in Australia must meet. Everhot Stainless Steel models perform up to 19% better than MEPS requirement. Performance varies by model, refer to Specification Table for individual models' performance.
- Guide only, subject to individual hot water consumption patterns.

Everhot SS 50L

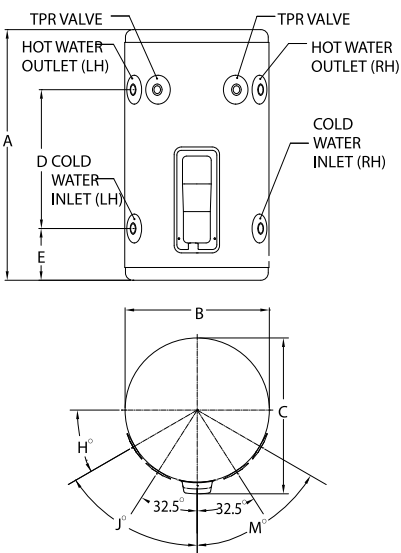

Everhot SS 250L and 315L

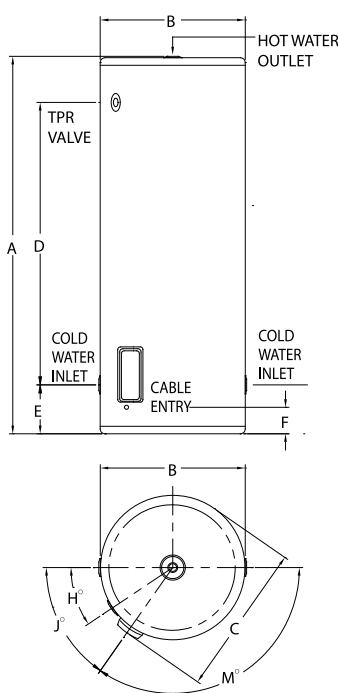

4 STAR GAS STORAGE



GAS



4 STAR
RATING

2 - 5

PEOPLE⁸

248L or
283L

FIRST HOUR
CAPACITY⁹

7
YEAR

CYLINDER
WARRANTY¹⁰

Everhot 4 Star gas storage water heaters are an ideal replacement for older 3 star gas models. They are easy to retrofit, and with superior energy efficiency, they'll reduce running costs too. They recover 113L/hr to deliver between 248L to 283L of hot water in the first hour (model dependant)⁹.

FEATURES

- 4 Star energy efficiency
- Two sizes: 135L and 170L capacity
- Natural gas models
- 248L/283L first hour capacity of hot water⁹
- Strong recovery: 113L/hr¹¹
- Easy, fast replacement for 3 Star units – same dimensions and fittings
- Outdoor installation
- Made in Australia
- Mains pressure
- 7 Year cylinder warranty¹⁰
- Full warranty support through a comprehensive national service network



SPECIFICATIONS		135L	170L
4 Star Gas Storage	Everhot Model Number	218135	218170
	Reece Product Code	1303568	1303570
AGA Gas Energy Rating		4 stars	4 stars
Installation		External only	External only
Suitable for no. of people⁸			
Moderate Climate		2-4	3-5
Cool Climate		2-3	3-4
Storage Capacity	Litres	135	170
Recovery Rate @ 45°C Rise ¹¹	L/hr	113	113
First Hour Capacity ⁹	Litres	248	283
Anodes		2	2
Hourly Gas Consumption			
Natural Gas	MJ	27	27
Max. Supply Pressure			
with ECV	kPa	960	960
without ECV	kPa	1120	1120
T&PR Valve Setting	kPa	1400	1400
Water Hot and Cold Connections		Rp ¾	Rp ¾
Gas Connections		Rp ½	Rp ½
Dimensions			
A	mm	1558	1858
B	mm	422	422
C	mm	502	502
D	mm	988	1213
E	mm	328	403
F	mm	298	298
G	mm	1478	1778
K	mm	473	473
L	mm	208	208
N	mm	160	160
Approx. Weight (inc. packaging)	kg	69	80

Technical data is subject to change.

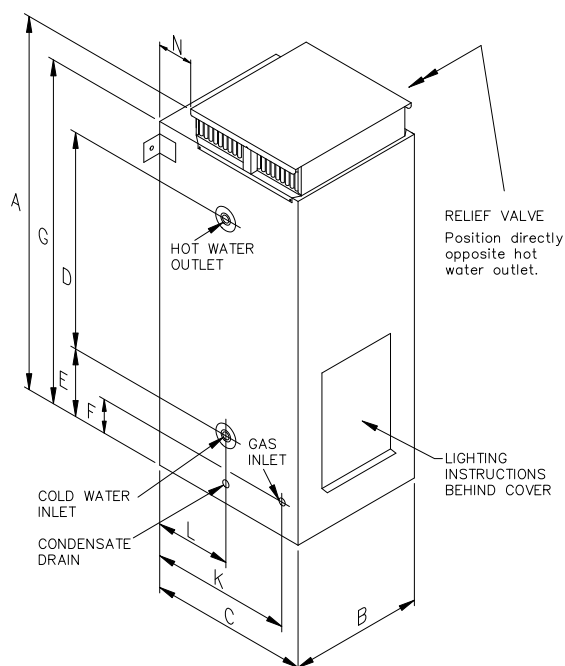

8. Guide only, subject to individual hot water consumption patterns.
9. First hour capacity is the storage capacity plus nominal first hour recovery rate at 45°C temperature rise using Natural Gas.
10. Warranty: 7 years parts on Cylinder, 1 years parts and labour warranty on all components, for Domestic (non-Commercial) installations. Conditions apply. See the Everhot warranty set out in the Owner's Guide and Installation Instructions or view online at www.reece.com.au/Everhot.
11. Calculated from output (in kW) as marked on the water heater.



5 STAR GAS STORAGE



GAS



5 STAR
RATING



PEOPLE¹²



FIRST HOUR
CAPACITY¹³



CYLINDER
WARRANTY¹⁵



Everhot 5 Star gas storage water heaters are an ideal storage solution when building new, or upgrading from 3 Star gas models. They can achieve their 5 Star energy efficiency rating without the need to connect to power, and avoid the requirement to upgrade your gas line. With a high powered burner, they recover 142L/hr to deliver between 272L to 302L of hot water in the first hour (model dependant)¹³, which is more than most people will ever need.

FEATURES

- 5 star energy efficiency
- Natural gas models
- Strong recovery: 142L/hr¹⁴
- 272L/302L first hour capacity of hot water¹³
- Compact – 490mm diameter for easy replacement of 3 Star gas water heaters
- No power connection required
- Runs on a standard ½” gas line
- Made in Australia
- Outdoor installation
- Mains pressure
- 10 Year cylinder warranty¹⁵
- Full warranty support through a comprehensive national service network



SPECIFICATIONS		130L	160L
5 Star Gas Storage	Everhot Model Number	252265	252295
	Reece Product Code	1303571	1303573
AGA Gas Energy Rating		5.3 stars	5.3 stars
Installation		External only	External only
Suitable for no. of people¹²			
Moderate Climate		2-4	3-5
Cool Climate		2-3	3-4
Storage Capacity	Litres	130	160
Recovery Rate @ 45°C Rise ¹⁴	L/hr	142	142
First Hour Capacity ¹³	Litres	272	302
Anodes		2	2
Hourly Gas Consumption			
Natural Gas	MJ	30	30
Max. Supply Pressure			
with ECV	kPa	960	960
without ECV	kPa	1120	1120
T&PR Valve Setting	kPa	1400	1400
Water Hot and Cold Connections		Rp ¾	Rp ¾
Gas Connections		Rp ½	Rp ½
Dimensions			
A	mm	1602	1902
B	mm	490	490
C	mm	559	559
D	mm	988	1213
E	mm	330	404
F	mm	300	300
G	mm	600	600
K	mm	523	523
L	mm	242	242
M	mm	297	297
N	mm	97	97
Approx. Weight (inc. packaging)	kg	80	89

Technical data is subject to change.

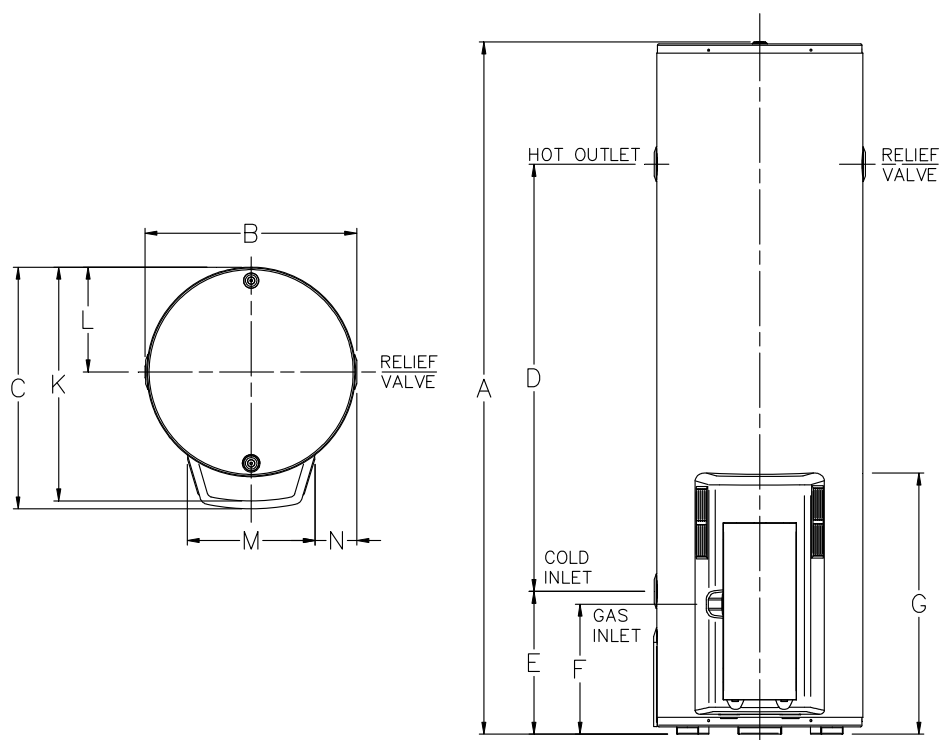

12. Guide only, subject to individual hot water consumption patterns.

13. First hour capacity is the storage capacity plus nominal first hour recovery rate at 45°C temperature rise using Natural Gas.

14. Calculated from output (in kW) as marked on the water heater.

15. Warranty: 10 years parts on Cylinder, 1 years parts and labour warranty on all components, for Domestic (non-Commercial) installations. Conditions apply. See the Everhot warranty set out in the Owner's Guide and Installation Instructions or view online at www.reece.com.au/Everhot.



450+ STAINLESS STEEL 5 STAR GAS STORAGE



GAS



5 STAR
RATING



PEOPLE¹⁷



FIRST HOUR
CAPACITY¹⁸



CYLINDER
WARRANTY¹⁶



NEW Everhot 450+ Stainless Steel Gas Storage water heater provides a first hour delivery of over 450 litres of 45°C hot water¹⁸.

The inbuilt tempering provides tempered (maximum 50°C) hot water without the need for a separate tempering valve.

The unique 'dual temperature' feature allows you to plumb tempered hot water (maximum 50°C) to fixtures used for personal hygiene, and full temperature 75°C hot water to where it's needed most (kitchen and laundry).

5 Star energy efficiency to save money.

FEATURES

- 450L+ first hour hot water delivery (45°C)¹⁸
- Dual temperature capability:
 - Tempered 50°C maximum side outlet
 - Full temperature 75°C top outlet, no need for a separate tempering valve
- Stainless steel cylinder resists corrosion longer than traditional enamelled steel
- No anode, for lower maintenance costs
- 5 Star energy efficiency
- Lighter than traditional enamelled steel cylinder models, for easier installation
- Rp³/₄" female water connections, for easier installation
- 10 Year Cylinder Warranty¹⁶
- Made in Australia
- Natural Gas only
- Full warranty support through a comprehensive national service network



SPECIFICATIONS

450+ Stainless Steel Gas		Everhot Model Number	2AG450N0
		Reece Product Code	1360669
AGA Gas Energy Rating			5 stars
Installation			External only
Suitable for no. of people¹⁷			
Moderate Climate			3-6
Cool Climate			3-5
Storage Capacity	Litres		155
Recovery Rate @ 45°C Rise	L/hr		185
First Hour Capacity ¹⁸	Litres		450
Gas Type			Natural Gas Only
Hourly Gas Consumption			
Natural Gas	MJ		40
Max. Supply Pressure			
with ECV	kPa		960
without ECV	kPa		1120
T&PR Valve Setting	kPa		1400
Water Connection			
Cold Inlet			Rp ¾
Outlet - Top (Maximum 75°C)			Rp ½
Outlet - Side (Maximum 50°C)			Rp ¾
Gas Connection			Rp ½" Flare Compression
Dimensions			
A	mm		1635
B	mm		520
C	mm		610
D	mm		330
E	mm		360
F	mm		840
G	mm		415
H	mm		52
J	mm		263
Approx. Weight (inc. packaging)	kg		65

Technical data is subject to change.

High delivery, stainless steel quality plus unique dual temperature capability.

The NEW Everhot 450+ Stainless Steel gas storage water heater's unique technology enables first hour delivery of over 450 litres of 45°C hot water¹⁸.

Inbuilt tempering capability limits outlet water temperature to a maximum of 50°C in accordance with AS 3498.

When the 'dual temperature' feature (using BOTH the tempered and full temperature hot water outlets) is used, the tempered lower side outlet may be plumbed to sanitary fixtures used for personal hygiene (as required by AS/NZS 3500.4), usually in the bathroom, while the full temperature 75°C top outlet may be plumbed to the kitchen & laundry, where hotter water is required.

Everhot Stainless Steel water heaters are not recommended for installation in some areas.

Refer to www.reece.com.au/Everhot for details of areas not recommended and where, if installed, product is not covered by warranty.

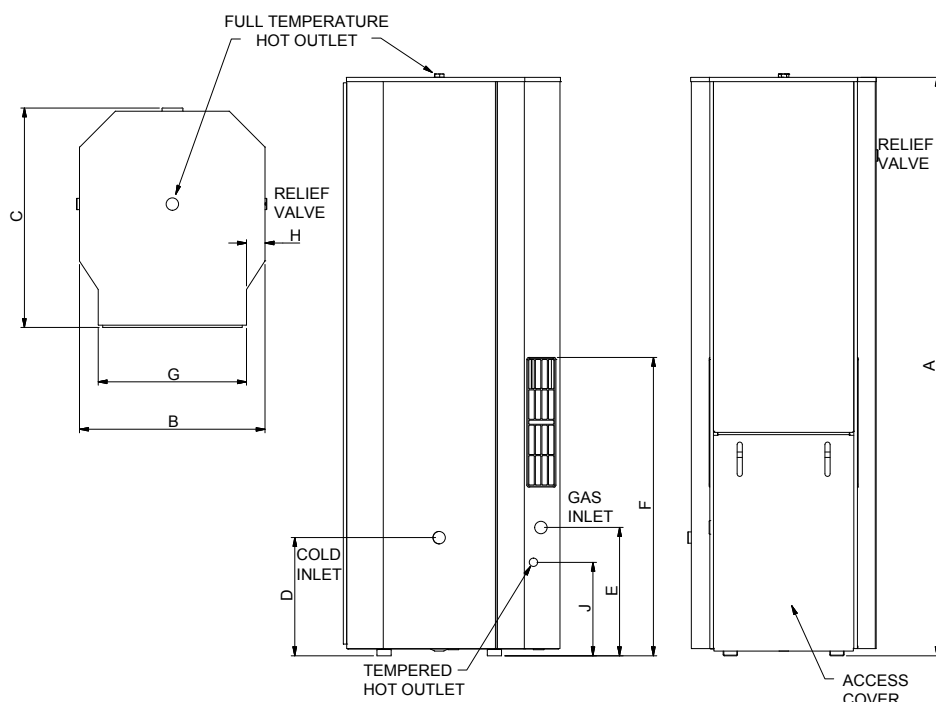

16. Warranty: 10 years parts on cylinder, 1 years parts and labour on all other components, for Domestic (non-Commercial) installations. Conditions apply. See the Everhot warranty set out in the Owner's Guide and Installation Instructions or view online at www.reece.com.au/Everhot.
17. Guide only, subject to individual hot water consumption patterns.
18. First Hour Capacity of at least 450L of hot water delivered at 45°C from the tempered outlet, based on 20°C inlet cold water and maximum gas control setting. First hour capacity is the storage capacity plus nominal first hour recovery rate at a delivered temperature of 45°C, from 20°C inlet water and at maximum gas control setting.
19. ECV not supplied.



EVERHOT PRO (HEAVY DUTY ELECTRIC)



ELECTRIC

50L
315L

DELIVERY

3 x 3.6kW
3 x 4.8kW

INPUT²⁰

5
YEAR

CYLINDER
WARRANTY²¹

Indoor/
Outdoor

INSTALLATION

Everhot PRO Heavy Duty Electric is a robust commercial water heater range designed to provide between 240 and 560 litres of hot water in the first hour and 190 to 250L/hr recovery hour after hour at 50°C temperature rise.

FEATURES

- Available in the most popular capacities of 50L and 315L with a choice of either 3 x 3.6kW or 3 x 4.8kW elements²⁰
- Suitable for indoor and outdoor installation
- Direct replacement for the most popular heavy duty electric models
- Heavy duty enamel and larger anode²² provide long service life
- Trade adjustable thermostats for sanitising applications
- Manifold multiple units together for greater capacity and output
- Mains pressure
- Made in Australia
- 5 year cylinder warranty²¹
- Full warranty support through a comprehensive national service network



SPECIFICATIONS		50L	315L
Everhot PRO Heavy Duty Electric	Everhot Model Number	623050	623315
	Reece Product Code	1306818	1306819 (3.6kW) and 1306820 (4.8kW)
Hot Water Delivery	Litres	50	315
First Hour Delivery - 3.6kW	Litres	240	500
First Hour Delivery - 4.8kW	Litres	-	560
Recovery at 50°C rise - 3.6kW	Litres	190	190
Recovery at 50°C rise - 4.8kW	Litres	-	250
T&PR Valve	kPa	1000	1000
ECV Setting	kPa	850	850
Maximum Supply Pressure			
without ECV	kPa	800	800
with ECV	kPa	680	680
Thermostat Setting (Maximum)	°C	75	77
Water Hot and Cold Connections	BSPF	Rp 1 $\frac{1}{4}$	Rp 1 $\frac{1}{4}$
T&PR Connection	BSPF	Rp $\frac{3}{4}$	Rp $\frac{3}{4}$
kW Rating	3.6	✓	✓
	4.8	-	✓
Dimensions			
A	mm	675	1640
B	mm	435	640
C	mm	475	680
D	mm	405	1294
E	mm	93	128
F	mm	83	130
H	degrees	30	32
J	degrees	90	90
Approx. Weight (inc. packaging)	kg	32	94

Technical data is subject to change.

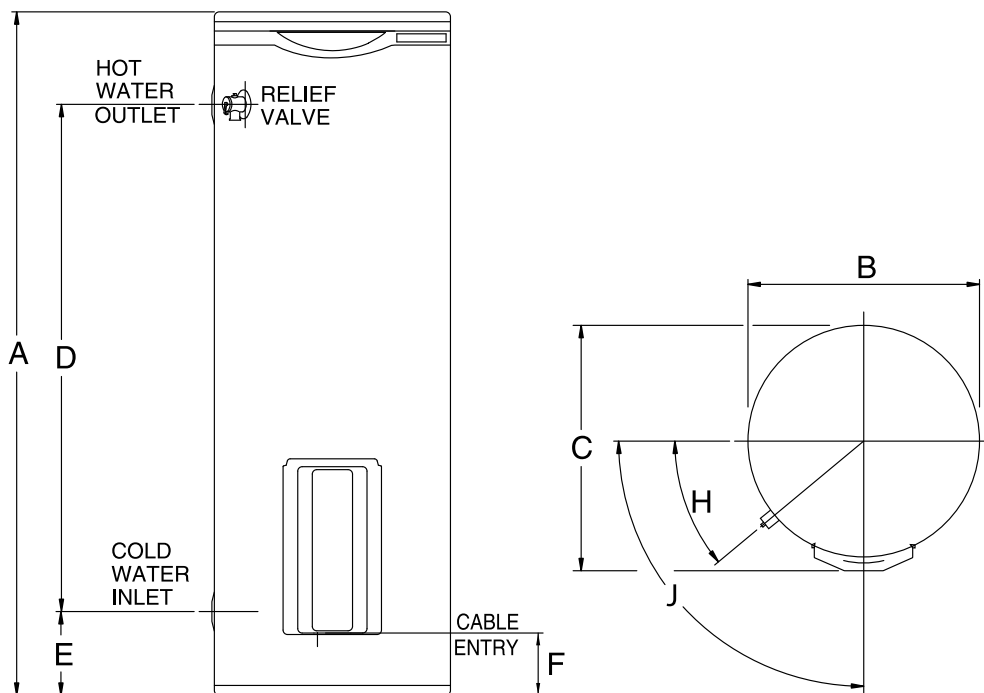

Note: Allow additional top clearance for anode replacement.

ELECTRICAL CONNECTION

Everhot PRO commercial electric water heaters can be wired using a single phase 240 Volts AC or 3 phase 415 Volts AC “star connected” supply, one phase per element.

MANIFOLD ARRANGEMENT

Hot header assembly

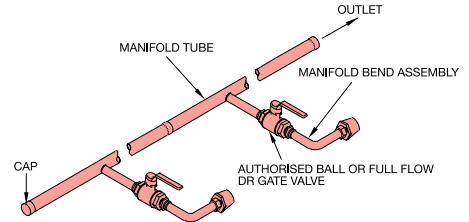

Cold header assembly

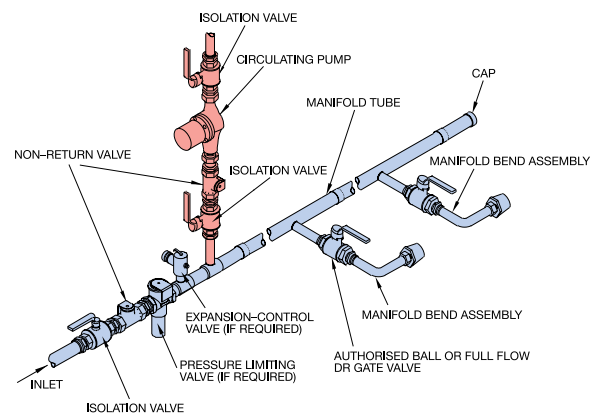

20. 3 x 3.6kW available in 50L and 315L. 3 x 4.8kW available in 315L.
21. Warranty: 5 Year cylinder warranty, 1 Year parts and labour on all other components in commercial installations. Conditions apply. See the Everhot warranty set out in the Owner's Guide and Installation Instructions or view online at www.reece.com.au/Everhot.
22. Black anode suitable up to 600mg/L Total Dissolved Solids only available.



HEAVY DUTY GAS



GAS

260L
275L

CAPACITY

51 MJ/hr
200 MJ/hr

INPUT

5
YEAR

CYLINDER
WARRANTY²³

Indoor/
Outdoor

INSTALLATION

Everhot Heavy Duty Gas is a robust commercial water heater range designed to provide between 380 and 970 litres of hot water in the first hour and 190 to 750L/hr recovery hour after hour at 50°C temperature rise.

FEATURES

- Available in the most popular capacities of 260L / 51MJ/hr input and 275L / 200MJ/hr input
- Indoor and outdoor natural gas models available
- Direct replacement for the most popular heavy duty gas models
- Heavy duty enamel and multiple anodes²⁴ provide long service life
- Indoor 275 model has automatic flue damper reducing heat loss by up to 60% compared to AGA maximum allowance
- Hot surface ignition on 275L models
- 82°C capable for sanitising applications on 275L models
- Manifold multiple units together for greater capacity and output
- Mains pressure
- Made in Australia
- 5 year cylinder warranty²³
- Full warranty support through a comprehensive national service network



SPECIFICATIONS		OUTDOOR MODELS		INDOOR MODELS	
Heavy Duty Gas	Everhot Model Number	632260	635275	622260	625275
	Reece Product Code	1306823	1306824	1306821	1306822
Storage Capacity	Litres	260	275	260	275
Thermal Input (natural gas)	MJ/hr	51	200	51	200
Recovery @ 50°C rise	L/hr	190	750	190	750
First Hour Delivery	L	380	970	380	970
Water Hot and Cold Connections	BSPF	Rp 1¼	Rp 1¼	Rp 1¼	Rp 1¼
Gas Connection	BSPF	Rp ½	Rp ¾	Rp ½	Rp ¾
T&PR Valve Connection	BSPF	Rp ¾	Rp ¾	Rp ¾	Rp ¾
T&PR Valve Setting	kPa	1000	1000	1000	1000
ECV	kPa	850	850	850	850
Max. Water Supply Pressure					
without ECV fitted	kPa	800	800	800	800
with ECV fitted	kPa	680	680	680	680
Max. Thermostat Setting	°C	65	82	65	82
Min. Thermostat Setting	°C	off	60	off	60
Electrical Connection		–	2m 10A plug and lead	–	2m 10A plug and lead
Electrical Rating 240V 50Hz		–	250 Watts / 1.1 Amps	–	150 Watts / 0.65 Amps
Maintenance Rate	MJ/day	30.7	50.7	33.9	26.1
Dimensions					
A	mm	1640	1885	1660	1910
B	mm	590	645	590	645
C	mm	680	780	670	780
D	mm	990	1454	990	1454
E	mm	330	704	330	704
F	mm	295	341	297	341
G	mm	1520	1706	1520	1706
H	degrees	27	33	27	33
K	mm	655	692	655	692
M	mm	–	–	100	200
P	mm	420	320	–	–
Approx. Weight (inc. packaging)	kg	112	170	102	161

Technical data is subject to change.

Outdoor Models

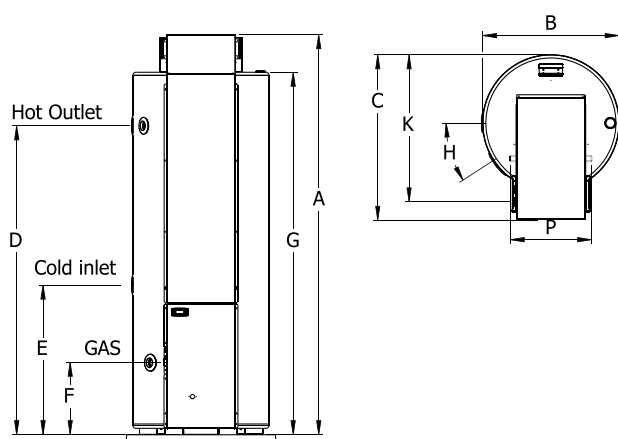

Indoor Models

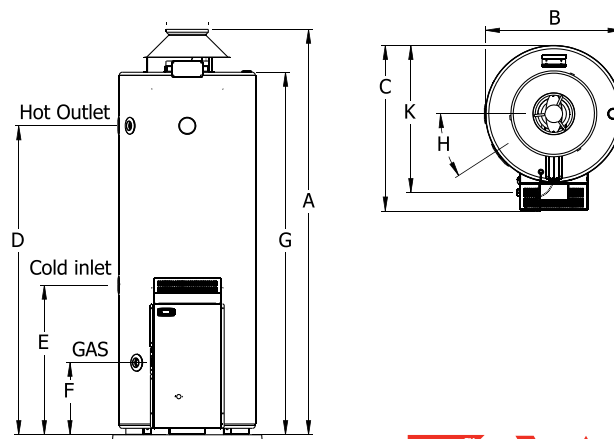

23. Warranty: 5 Year cylinder warranty, 1 Year parts and labour on all other components in commercial installations. Conditions apply. See the Everhot warranty set out in the Owner's Guide and Installation Instructions or view online at www.reece.com.au/Everhot.

24. Black anode suitable up to 600mg/L Total Dissolved Solids only available.



BOILING WATER



ELECTRIC

3L
5L

CAPACITY

103 -
135

CUPS/HR^{25,27}

5
YEAR

TANK
WARRANTY²⁸



ECO-mode is a one-button control that gives you boiling water with reduced energy consumption

Everhot boiling water is an above bench style boiling water unit that provides a cost effective solution for a wide range of installations. It comes in both 3L and 5L models and includes an ECO-mode to reduce energy consumption when not in use. Its white powder coated finish is easy to clean, and the unit is backed by a 5 year tank replacement warranty.²⁸

FEATURES

- Designed for a wide range of installations
- Available in 3L and 5L models
- Above bench mounting
- ECO-mode is a unique one-button control that gives you boiling water with reduced energy consumption²⁶
- Easy to clean white powder coat finish
- Automatic safety devices safeguard against unit boiling dry
- Automatic calibration of boiling point for altitude of the unit's installation
- LED display indicates heating status
- Plug-in electrical connection
- Made in New Zealand
- 5 year tank replacement warranty²⁸
- Full warranty backing through a national service network

SPECIFICATIONS		3L	5L
Boiling Water	Everhot Model Number	72303W-AU	72305W-AU
	Reece Product Code	1306816	1306817
Capacity	Litres	3	5
Delivery – Initial	Litres	3.5	6
	Cups ²⁷	20	35
Recovery	Cups/hr ²⁷	103	135
Min. Water Pressure	kPa	50	50
Max. Water Pressure	kPa	1000	1000
Input	kW	1.8	2.4
Electrical Connections		Supplied with 10 amp 3 pin plug and flex	Supplied with 10 amp 3 pin plug and flex
Water Hot and Cold Connections		G ½ (½ BSP)	G ½ (½ BSP)
Colour		white	white
Dimensions			
A	mm	283	336
B	mm	160	192
C	mm	435	465
D	mm	280	312
E	mm	65	65
F	mm	45	45
G	mm	50	50
H	mm	23	23
M	mm	142	168
N	mm	238	270
Approx. Weight (inc. packaging)	kg	7.7	9.4
Approx. Weight (full)	kg	10	15

Technical data is subject to change.

25. Recovery based on a 77°C rise.

26. Potential energy consumption savings values are approximate and provided for general reference purposes only. Actual heat loss reductions will vary depending on the system installed, regional temperatures, geographical location and other factors.

27. Cup size is 170mL.

28. Warranty: 2 Years, Parts and Labour, 5 year tank replacement. Conditions apply. See the Everhot warranty set out in the Owner's Guide and Installation Instructions or view online at www.reece.com.au/Everhot.

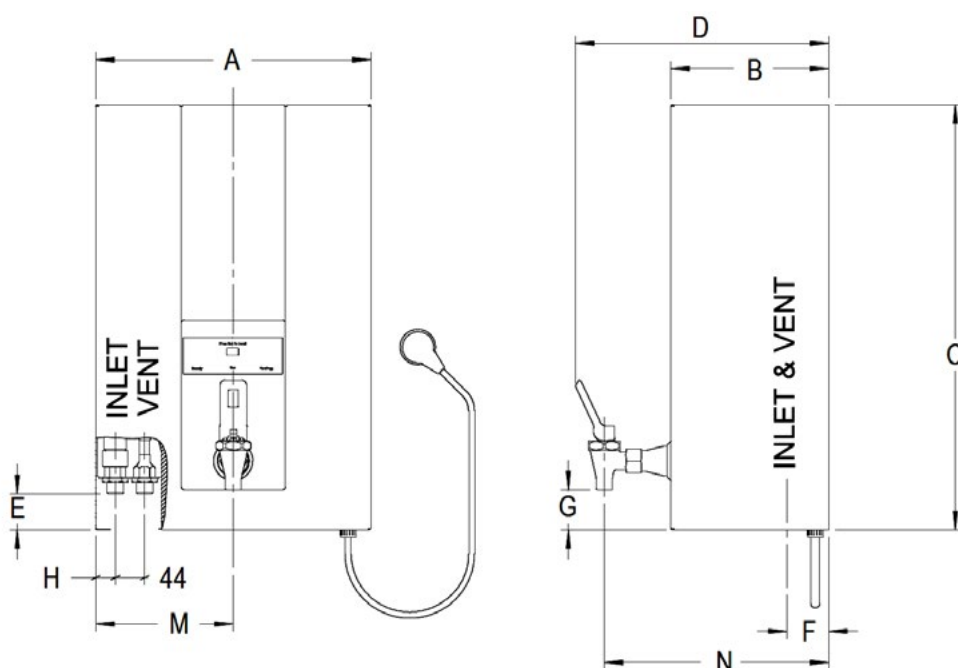



www.reece.com.au/Everhot

Everhot® is a Registered Trademark of Rheem Australia Pty Ltd.
Materials and data are subject to change without notice.

DECEMBER 2020

Brochure Code: 2130177